

## mall sihlcity zürich

reflexion ag

hardturmstrasse 123  
8005 zurich switzerland

phone +41 44 355 51 11  
fax +41 44 355 51 10

mail@reflexion.ch  
www.reflexion.ch



The appeal of the Sihlcity Mall lies in its outstanding atmosphere.

The basic structure of the mall is divided in three areas, each pervaded by daylight through its oval atrium.

At nightfall, spotlights seem to gleam directly from the sky.

2700 LED lights, embedded into the concrete of the oval balustrades glisten on all four public floors of the shopping mall. The color mode of those LED's changes in slow, barely visible sequences. In addition, colours can be adapted to the seasons. More than 1500 further lights - direct as well as diffused - produce atmospheric lighting throughout the mall.

Client:

Credit Suisse Asset Management

Architectur:

Theo Hotz AG, Zürich

Opening:

March 2007

Scope of Work:

General light planning

Project focus:

Mall- und retail lighting



1

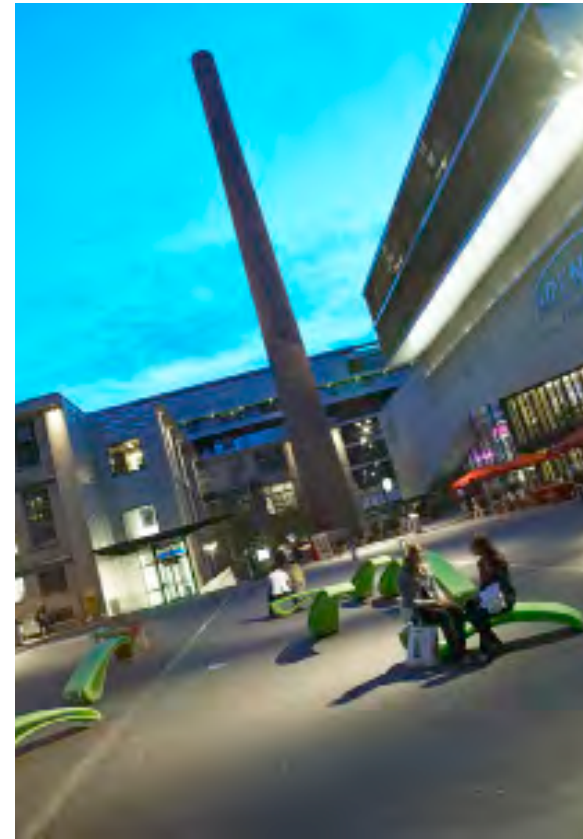

4



2



3

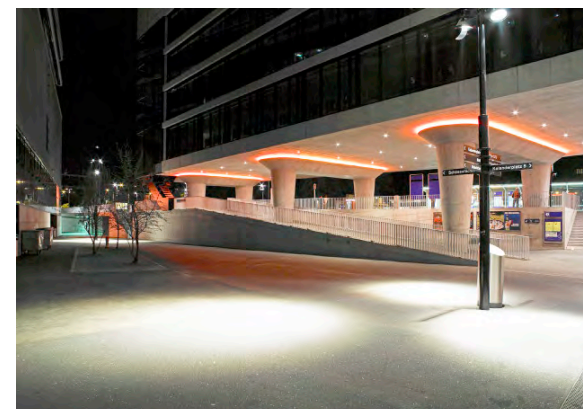

5

Photo on front page  
Shopping mall

- 1 Kalendarplatz
- 2 Shopping mall
- 3 Kalendargasse
- 4 Kalendarplatz
- 5 SZU stop