

tamina therme bad ragaz

reflexion ag

hardturmstrasse 123
8005 zürich switzerland

phone +41 44 355 51 11
fax +41 44 355 51 10

mail@reflexion.ch
www.reflexion.ch



Since the 16th century, the water from the Tamina spring is used for healing and therapeutic treatments.

The first indoor swimming pool was established in 1872. In 2002, the architects Smolenicky & Partners from Zuerich won the project competition for the aesthetic adjustment of the outdoor pool at the new building, and Reflexion joined the project as lighting designer in 2007.

The wooden construction stands out with its both classic and futuristic design and creates a whole new sensation of space. The incisive rooms' structures and shapes are all painted and decorated in white to generate calmness. The lighting design as well as the architecture follow a strong, general concept which allows having only very little different design elements.

Client:

Grand Hotels Bad Ragaz

Architectur:

Smolenicky & Partner, Zürich

Opening:

Juni 2009

Scope of Work:

General light planning

Project focus:

Wellness

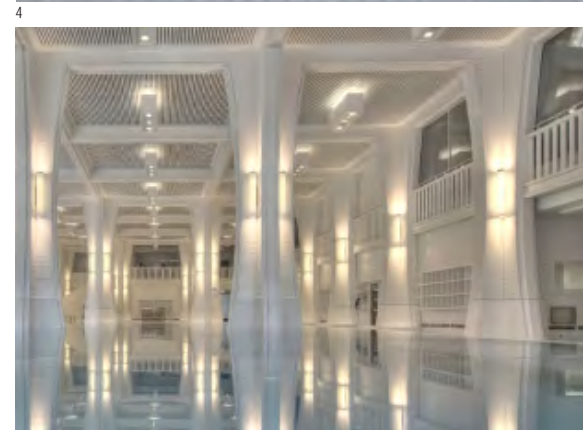
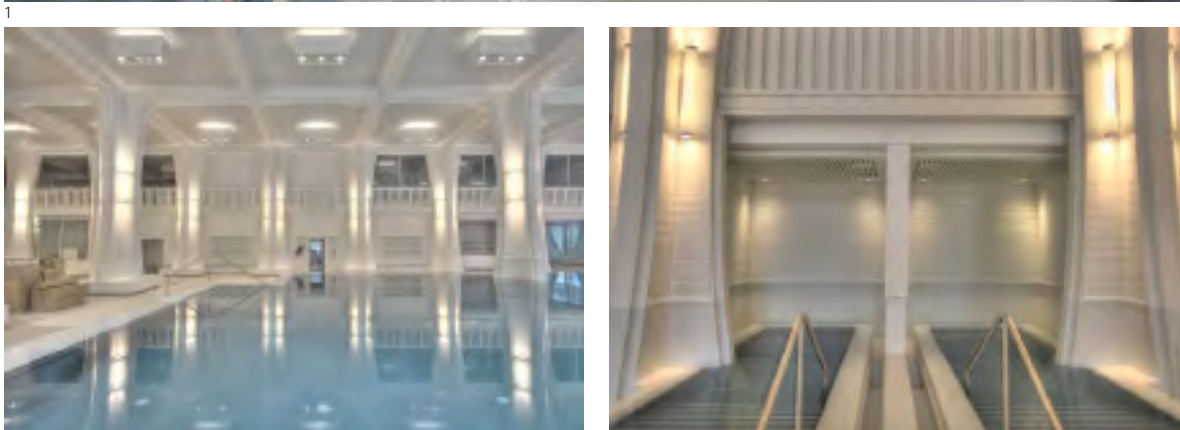

1 - 5 Indoor pool

2

5